

Hoist Rings

Std. Clevis Part Number	B	Thread Size A	Thread Length C	Inches				Std. H	Long H	Load* Capacity (lbs.)	Torque† (ft. lbs.)	Wt. (lbs.)
				D	E	F	G					
16202	2.67	5/16-18	9/16	.75	.43	.38	1.84	1 1/4	—	800	7	.3
16204	2.67	3/8-16	9/16	.75	.43	.38	1.84	1 1/4	—	1000	12	.3
16208	4.78	1/2-13	3/4	1.50	.88	.75	3.52	2 3/8	4 1/4	2500	28	2.5
16210	4.78	1/2-13	1	1.50	.88	.75	3.52	2 3/8	4 1/4	2500	28	2.5
16212	4.78	1/2-13	1 1/4	1.50	.88	.75	3.52	2 3/8	4 1/4	2500	28	2.5
16215	4.78	5/8-11	1	1.50	.88	.75	3.52	2 1/4	4 3/16	4000	60	2.7
16217	4.78	5/8-11	1 1/4	1.50	.88	.75	3.52	2 1/4	4 3/16	4000	60	2.7
16220	4.78	3/4-10	1	1.50	.88	.75	3.52	2 1/8	4	5000	100	3.0
16221	4.78	3/4-10	1 1/2	1.50	.88	.75	3.52	2 1/8	4	5000	100	3.0
16225	6.52	7/8-9	1	2.31	1.40	1.00	5.14	2 13/16	4 3/8	8000	160	7.0
16227	6.52	7/8-9	1 1/4	2.31	1.40	1.00	5.14	2 13/16	4 3/8	8000	160	7.0
16230	6.52	1-8	1 1/2	2.31	1.40	1.00	5.14	2 11/16	4 3/8	10000	230	7.5
16232	6.52	1-8	2 1/4	2.31	1.40	1.00	5.14	2 11/16	4 3/8	10000	230	7.5
16235	8.73	1 1/4-7	1 3/8	3.19	1.75	1.25	6.50	4 1/4	—	15000	470	14.0
16237	8.73	1 1/4-8	1 3/8	3.19	1.75	1.25	6.50	4 1/4	—	15000	470	14.0
16240	12.47	1 1/2-6	2 3/4	4.19	2.25	1.75	8.55	6 1/2	—	24000	800	33.0
16242	12.47	1 1/2-8	2 3/4	4.19	2.25	1.75	8.55	6 1/2	—	24000	800	33.0
16245	12.47	2-4 1/2	3 3/8	4.19	2.25	1.75	8.55	6 1/8	—	30000	800	36.0
16247	12.47	2-8	3 3/8	4.19	2.25	1.75	8.55	6 1/8	—	30000	800	36.0
16246	16.50	2 1/2-4	4	5.75	3.00	2.25	11.72	8 1/2	—	50000	2100	89.0

* Stated load capacity based on specific thread torques as shown in chart.

† It is recommended that these torques be used when installing hoist rings.
All dimensions in inches and pounds.

Replacement Bolt Kits available. Call for quote.

Bolt Kit contains bolt and retaining ring. Bolt Kits for Diamond D Hoist Rings available upon request.

Center Pull Style

- Full swivel and pivot action
- Forged
- Alloy steel
- Black oxide body finish with zinc plated gold washer
- Rated at 5:1 strength factor

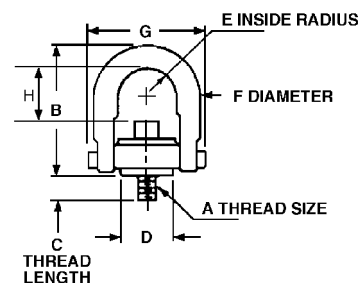

Std. Clevis Part Number	Thread Size A	B	Thread Length C	D	E	F	G	H	Load* Capacity (Kg.)	Torque† (ft. lbs.)	Wt. (Kg.)
16508M	M8 x 1.25	67.8	12.5	19.0	10.9	9.7	46.7	32.0	400	1.0	.17
16510M	M10 x 1.50	67.8	17.5	19.0	10.9	9.7	46.7	30.0	450	1.7	.17
16512M	M12 x 1.75	121.4	19.0	38.1	22.4	19.0	89.4	60.5	1050	3.8	1.08
16516M	M16 x 2.0	121.4	29.0	38.1	22.4	19.0	89.4	56.5	1900	8.2	1.12
16520M	M20 x 2.5	121.4	34.0	38.1	22.4	19.0	89.4	52.5	2150	13.6	1.19
16524M	M24 x 3.0	165.6	37.0	58.7	35.6	25.4	130.6	69.0	4200	31.0	3.10
16530M	M30 x 3.5	221.7	41.9	81.0	44.5	31.7	165.1	107.4	7000	60.0	6.30
16536M	M36 x 4.0	316.7	63.5	106.4	57.2	44.4	217.2	166.5	11000	100.0	15.50
16542M	M42 x 4.5	316.7	68.0	106.4	57.2	44.4	217.2	160.5	12500	100.0	16.00
16548M	M48 x 5.0	316.7	88.0	106.4	57.2	44.4	217.2	154.5	13500	100.0	16.80

* Stated load capacity based on specific thread torques as shown in chart.

† It is recommended that these torques be used when installing hoist rings.
All dimensions in millimeters and weights in kilograms.

Replacement Bolt Kits available. Call for quote.

Bolt Kit contains bolt and retaining ring. Bolt Kits for Diamond D Hoist Rings available upon request.

Center Pull Style – Metric

- Full swivel and pivot action
- Alloy steel
- Black oxide body finish with zinc plated gold washer
- Rated at 5:1 strength factor