

Miscellaneous

Plastic Yoke • Reinforced



| Stock No. | Thread T | A | B | D | E | F | G | H | K | Approx. Wt. Per 100 Pcs. |
|-----------|----------|--------|-------|--------|-------|-------|-------|-------|-------|--------------------------|
| 69000 | 10-32 | 1.5625 | .3125 | 1.000 | .1875 | .4375 | .1875 | .5625 | .375 | 1.0 |
| 69005 | 1/4-28 | 2.000 | .4375 | 1.250 | .2812 | .6250 | .250 | .750 | .500 | 2.0 |
| 69010 | 5/16-24 | 2.250 | .500 | 1.4375 | .3437 | .750 | .3125 | .8125 | .5937 | 3.5 |
| 69015 | 3/8-24 | 2.500 | .6250 | 1.6250 | .4375 | .8750 | .375 | .894 | .6875 | 5.0 |
| 69020 | 1/2-20 | 3.000 | .8126 | 1.8750 | .5625 | 1.125 | .500 | 1.125 | .9375 | 10.0 |

Fabricated from a special compound by Celanese® of 40% fiberglass and 60% nylon, into which heat treated spring steel inserts are imbedded. Patented.

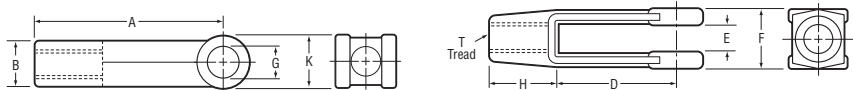

Forged Adjustable Yoke Ends • Carbon Steel



| Stock No. | Thread T | A | B | D | E | F | G | H | K | Approx. Wt. Per 100 Pcs. |
|-----------|----------|---------|--------|---------|--------|-------|------|-------|--------|--------------------------|
| 69105 | 1/4-28 | 2 | 7/16 | 1 1/4 | 9/32 | 5/8 | 1/4 | 3/4 | 1/2 | 7.0 |
| 69110 | 5/16-24 | 2 1/4 | 1/2 | 1 7/16 | 1 1/32 | 3/4 | 5/16 | 13/16 | 19/32 | 11.0 |
| 69115 | 3/8-24 | 2 1/2 | 5/8 | 1 5/8 | 7/16 | 7/8 | 3/8 | 7/8 | 1 1/16 | 17.0 |
| 69120 | 7/16-20 | 2 7/8 | 23/32 | 1 7/8 | 1/2 | 1 | 7/16 | 1 | 13/16 | 24.0 |
| 69122 | 1/2-13 | 3 | 1 3/16 | 1 7/8 | 9/16 | 1 1/8 | 1/2 | 1 1/8 | 1 5/16 | 39.0 |
| 69124 | 1/2-20LH | 3 | 1 3/16 | 1 7/8 | 9/16 | 1 1/8 | 1/2 | 1 1/8 | 1 5/16 | 39.0 |
| 69125 | 1/2-20 | 3 | 1 3/16 | 1 7/8 | 9/16 | 1 1/8 | 1/2 | 1 1/8 | 1 5/16 | 39.0 |
| 69126 | 1/2-20 | 4 3/16 | 1 3/16 | 3 1/16 | 9/16 | 1 1/8 | 1/2 | 1 1/8 | 1 5/16 | 44.0 |
| 69130 | 5/8-18 | 4 15/16 | 1 1/16 | 3 11/16 | 1 1/16 | 1 3/8 | 5/8 | 1 1/4 | 1 3/16 | 75.0 |
| 69132 | 5/8-11 | 4 15/16 | 1 1/16 | 3 11/16 | 1 1/16 | 1 3/8 | 5/8 | 1 1/4 | 1 3/16 | 75.0 |
| 69135 | 3/4-16 | 6 1/16 | 1 1/4 | 4 9/16 | 1 3/16 | 1 5/8 | 3/4 | 1 1/2 | 1 7/16 | 125.0 |
| 69136 | 3/4-10 | 4 | 1 1/8 | 2 3/4 | 1 1/16 | 1 1/2 | 5/8 | 1 1/4 | 1 3/8 | 76.0 |
| 69137 | 3/4-10 | 6 1/16 | 1 1/4 | 4 9/16 | 1 3/16 | 1 5/8 | 3/4 | 1 1/2 | 1 7/16 | 125.0 |
| 69138 | 3/4-16 | 4 | 1 1/8 | 2 3/4 | 1 1/16 | 1 1/2 | 5/8 | 1 1/4 | 1 3/8 | 76.0 |

UNC Course Threads available upon request. Zinc plating available. Call for quote.

Plain Yoke Ends • Forged • Carbon Steel • Self-Colored

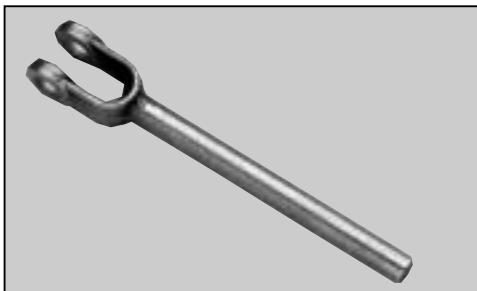

| Stock No. | Diameter | A | B | C | D | E | F | G | H | K | Approx. Wt. Per 100 Pcs. |
|-----------|----------|-------|------|---------|---------|--------|-------|-------|---------|---------|--------------------------|
| 69305*** | 1/4 | 1 3/4 | 1/4 | 1 9/32 | 5/8 | 9/32 | 5/8 | 1 1/4 | 1 1/8 | 1/2 | 16.0 |
| 69310 | 5/16 | 2 | 5/16 | 1 7/16 | 3/4 | 1 1/32 | 3/4 | 5/16 | 1 1/4 | 1 9/32 | 18.0 |
| 69315 | 3/8 | 2 1/8 | 3/8 | 1 33/64 | 27/32 | 7/16 | 7/8 | 3/8 | 1 9/32 | 1 1/16 | 28.0 |
| 69317 | 3/8 | 7 | 3/8 | 1 33/64 | 27/32 | 7/16 | 7/8 | 3/8 | 1 9/32 | 1 1/16 | 58.0 |
| 69320 | 7/16 | 2 1/4 | 7/16 | 1 33/64 | 1 | 1/2 | 1 | 7/16 | 1 1/4 | 1 3/16 | 39.0 |
| 69322 | 7/16 | 3 1/2 | 7/16 | 1 33/64 | 1 | 1/2 | 1 | 7/16 | 1 1/4 | 1 3/16 | 45.0 |
| 69325 | 1/2 | 2 1/2 | 1/2 | 1 11/16 | 1 1/8 | 9/16 | 1 1/8 | 1/2 | 1 3/8 | 1 5/16 | 51.0 |
| 69326 | 1/2 | 6 1/2 | 1/2 | 5 11/16 | 1 1/8 | 9/16 | 1 1/8 | 1/2 | 5 3/8 | 1 5/16 | 83.0 |
| 69330 | 5/8 | 2 7/8 | 5/8 | 1 53/64 | 1 7/16 | 1 1/16 | 1 3/8 | 5/8 | 1 7/16 | 1 3/16 | 76.0 |
| 69332 | 5/8 | 4 3/4 | 5/8 | 1 53/64 | 1 7/16 | 1 1/16 | 1 3/8 | 5/8 | 1 7/16 | 1 3/16 | 101.0 |
| 69335 | 3/4 | 3 5/8 | 3/4 | 2 25/64 | 1 11/16 | 1 3/16 | 1 5/8 | 3/4 | 1 15/16 | 1 7/16 | 128.0 |
| 69337 | 3/4 | 8 1/4 | 3/4 | 2 25/64 | 1 11/16 | 1 3/16 | 1 5/8 | 3/4 | 1 15/16 | 1 7/16 | 209.0 |
| 69345 | 1 | 6 | 1 | 3 3/64 | 2 1/2 | 1 1/16 | 2 1/8 | 1 | 3 1/2 | 1 15/16 | 340.0 |

Refer to line drawing above for dimensional reference.

***These products will be discontinued when stock is depleted.

Clevis Pins • Cold Headed • Self-Colored* • For Yoke Ends

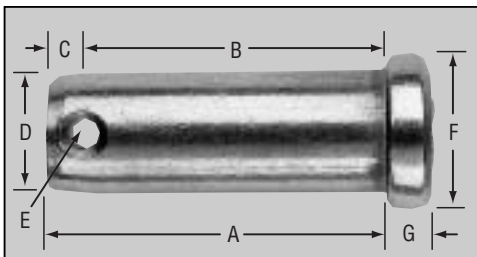

| Stock No. | A | B | C | D | E | F | G | Approx. Wt. Per 100 Pcs. |
|-----------|---------|---------|------|------|--------|-------|-------|--------------------------|
| 98305 | 49/64 | 49/64 | 3/32 | 1/4 | 5/64 | 3/8 | 3/32 | 1.4 |
| 98310 | 15/16 | 13/16 | 1/8 | 5/16 | 7/64 | 7/16 | 3/32 | 2.5 |
| 98315 | 1 1/16 | 1 5/16 | 1/8 | 3/8 | 7/64 | 1/2 | 1/8 | 4.0 |
| 98320 | 1 1/4 | 1 1/16 | 1/8 | 7/16 | 7/64 | 9/16 | 5/32 | 6.4 |
| 98325 | 1 23/64 | 1 13/64 | 5/32 | 1/2 | 9/64 | 5/8 | 5/32 | 9.0 |
| 98330 | 1 39/64 | 1 29/64 | 5/32 | 5/8 | 9/64 | 13/16 | 13/64 | 17.2 |
| 98335 | 1 29/32 | 1 23/32 | 3/16 | 3/4 | 1 1/64 | 15/16 | 1/4 | 28.8 |
| 98340 | 1 27/32 | 1 19/32 | 9/64 | 5/8 | 9/64 | 13/16 | 13/64 | 100.0 |

*Zinc plating available. Call for quote.