

# Miscellaneous

Stock No.	Overall Length A	Width of Pad B	Shank Dia. C	Length of Shank D	Thickness of Pad	Approx. Wt. Per 100 Pcs.
66310***	4 <sup>13</sup> / <sub>16</sub>	1 <sup>1</sup> / <sub>2</sub>	<sup>3</sup> / <sub>8</sub>	3	<sup>1</sup> / <sub>8</sub>	33.0

\*\*\*This product will be discontinued when stock is depleted.

Stock No.	Overall Length A	Width of Pad B	Shank Dia. C	Length of Shank D	Thickness of Pad	Approx. Wt. Per 100 Pcs.
66410	8 <sup>3</sup> / <sub>4</sub>	1	<sup>3</sup> / <sub>8</sub>	5 <sup>1</sup> / <sub>4</sub>	<sup>5</sup> / <sub>32</sub>	92.0
66420	6 <sup>3</sup> / <sub>4</sub>	1 <sup>1</sup> / <sub>4</sub>	<sup>1</sup> / <sub>2</sub>	3 <sup>3</sup> / <sub>4</sub>	<sup>5</sup> / <sub>32</sub>	115.0
66430***	5	1 <sup>1</sup> / <sub>4</sub>	<sup>3</sup> / <sub>8</sub>	2 <sup>1</sup> / <sub>2</sub>	<sup>5</sup> / <sub>16</sub>	74.0

\*\*\*This product will be discontinued when stock is depleted.

Stock No.	Length from Center of T A	Size of T		Shank Dia. D	Approx. Wt. Per 100 Pcs.
		B	C		
66000	2 <sup>1</sup> / <sub>2</sub>	<sup>1</sup> / <sub>4</sub> x	1 <sup>1</sup> / <sub>4</sub>	<sup>1</sup> / <sub>4</sub>	13.0
66005***	2	<sup>3</sup> / <sub>8</sub> x	2	<sup>3</sup> / <sub>8</sub>	25.0
66010	2 <sup>1</sup> / <sub>2</sub>	<sup>3</sup> / <sub>8</sub> x	1 <sup>1</sup> / <sub>4</sub>	<sup>3</sup> / <sub>8</sub>	30.0
66020	2 <sup>1</sup> / <sub>2</sub>	<sup>3</sup> / <sub>8</sub> x	2	<sup>3</sup> / <sub>8</sub>	22.0
66025	5	<sup>3</sup> / <sub>8</sub> x	1 <sup>3</sup> / <sub>4</sub>	<sup>3</sup> / <sub>8</sub>	41.0
66030	3 <sup>1</sup> / <sub>2</sub>	<sup>1</sup> / <sub>2</sub> x	1 <sup>7</sup> / <sub>8</sub>	<sup>1</sup> / <sub>2</sub>	47.0
66035	6	<sup>1</sup> / <sub>2</sub> x	3	<sup>1</sup> / <sub>2</sub>	95.0
66040***	3 <sup>1</sup> / <sub>2</sub>	<sup>1</sup> / <sub>2</sub> x	2	<sup>1</sup> / <sub>2</sub>	47.0
66045***	2 <sup>1</sup> / <sub>4</sub>	<sup>5</sup> / <sub>8</sub> x	2 <sup>1</sup> / <sub>2</sub>	<sup>5</sup> / <sub>8</sub>	65.0

\*\*\*These products will be discontinued when stock is depleted.

Stock No.	Maximum I.D. Eye	Minimum I.D. Eye	Thickness	Approx. Wt. Per 100 Pcs.
43000	1 <sup>1</sup> / <sub>16</sub>	1 <sup>1</sup> / <sub>2</sub>	<sup>3</sup> / <sub>8</sub>	33.0

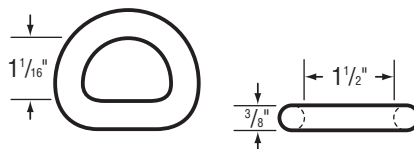

Stock No.	Size	Approx. Wt. Per 100 Pcs.
62000	Flat <sup>1</sup> / <sub>4</sub> x 1	50.0
62100	<sup>1</sup> / <sub>2</sub> Round	50.0

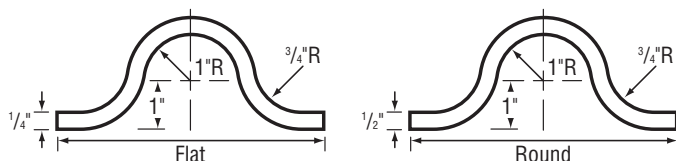

## Strap Ends

- Forged • Carbon Steel
- Self-Colored

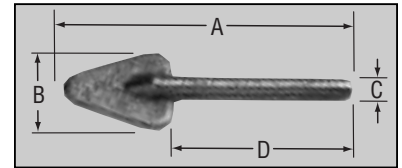

## Strap Ends

- Forged • Carbon Steel
- Self-Colored

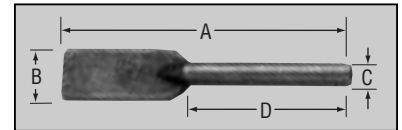

## Tee Bolts

- Forged • Carbon Steel
- Self-Colored

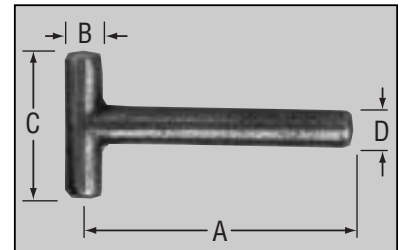

## Tarpaulin Ring

- Forged • Carbon Steel
- Self-Colored

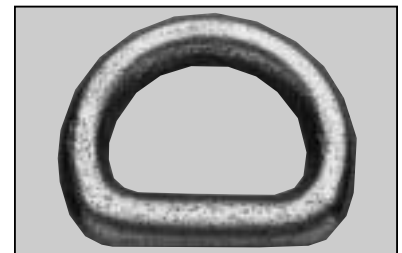

## Lifting Lugs

- Forged
- Carbon Steel
- Self-Colored

